

IEC Appliance Inlet C14 with Filter, Fuseholder 1- or 2-pole (5x20 mm or 6.3x32 mm), optional Voltage Selector (step switch)

Standard- or Medical-Filter



V-Lock



with voltage selector



without voltage selector



### Description

- Panel Mount:  
Screw-on mounting from front side
- 4 Functions:  
Appliance Inlet Protection class I, Fuseholder with interchangeable fuse drawer for Fuse-links 5x20 mm or 6.3x32 mm, with or without voltage selector (step switch), Line filter in standard and medical version
- Quick connect terminals 4.8 x 0.8 mm

### Approvals

- VDE Certificate Number: 40004665 (FKO, FKP, FKQ, FKR)
- UL File Number: E72928 (FKO, FKP, FKQ, FKR)

### Characteristics

- All single elements are already wired
- The fuse drawer "Fingerrip" can be removed by hand  
For added safety "Extra-Safe" fuse drawers are available  
Fuse drawer meets requirements of medical standard IEC/EN 60601-1  
The fuse drawer can only be opened with the aid of a tool  
The fuseholder is accessible from the equipment front
- Suitable for use in equipment according to IEC/UL 60950  
Suitable for use in medical equipment according to IEC/UL 60601-1

### Other versions on request

- Variant with notch for V-Lock mating Cordsets

### References

- Alternative: version without line filter [KEC](#)
- Alternative: Standard version

### Weblinks

[pdf-datasheet](#), [html-datasheet](#), [General Product Information](#), [Approvals](#), [CE declaration of conformity](#), [RoHS](#), [CHINA-RoHS](#), [Mating Connectors](#), [e-Shop](#), [SCHURTER-Stock-Check](#), [Distributor-Stock-Check](#), [CAD-Drawings](#), [Accessories](#), [Mounting instruction](#), [Detailed request for product](#)

Newly available variants corresponding to V-Lock mating cordset. The connector is equipped with a notch intended for use with the latching cordset. The cord latching system prevents against accidental removal of the cordset.

### Technical Data

|                           |   |                                   |  |
|---------------------------|---|-----------------------------------|--|
| Ratings IEC               | 1 - 10A @ Ta 40 °C / 250VAC; 50Hz   | Appliance-Inlet/-Outlet           | C14 acc. to IEC 60320,   |
| Ratings UL/CSA            | 1 - 10A @ Ta 40 °C / 125VAC; 60Hz   |                                   | UL 498, CSA C22.2 no. 42 (for cold conditions) pin-temperature 70 °C, 10A, Protection Class I          |
| Leakage Current           | standard < 0.5 mA (250 V / 60Hz)<br>medical < 5 µA (250 V / 60 Hz)          | Fuseholder                        | 1 or 2 pole, Shocksafe category PC2 acc. to IEC 60127-6,<br>for fuse-links 5 x 20 or 6.3 x 32 mm       |
| Dielectric Strength       | > 1.7 kVDC between L-N<br>> 2.7 kVDC between L/N-PE<br>Test voltage (2 sec) | Rated Power Acceptance @ Ta 23 °C | 5 x 20: 2.5W (1 pole)/ 2W (2-pole) per pole<br>6.3 x 32: 3.15W (1 pole)/ 2.5W (2-pole) per pole        |
| Allowable Operation Temp. | -25 °C to 85 °C   | Power Acceptance @ Ta > 23 °C     | Admissible power acceptance at higher ambient temperature see derating curves                          |
| Climatic Category         | 25/085/21 acc. to IEC 60068-1   | Voltage Selector                  | optional, step, 3 pos.   |
| Degree of Protection      | from front side IP 40 acc. to IEC 60529                                     | Line Filter                       | Standard and Medical Version, IEC 60939, UL 1283, CSA C22.2 no. 8<br><a href="#">Technical Details</a> |
| Protection Class          | Suitable for appliances with protection class I acc. to IEC 61140           | MTBF                              | > 1'700'000h acc. to MIL-HB-217 F  |
| Terminal                  | Quick connect terminals 4.8 x 0.8 mm  |                                   |  |
| Panel Thickness s         | Screw: max 8 mm<br>Mounting screw torque max 0.5 Nm                         |                                   |  |
| Material: Housing         | Thermoplastic, black, UL 94V-0  |                                   |  |

## Dimensions

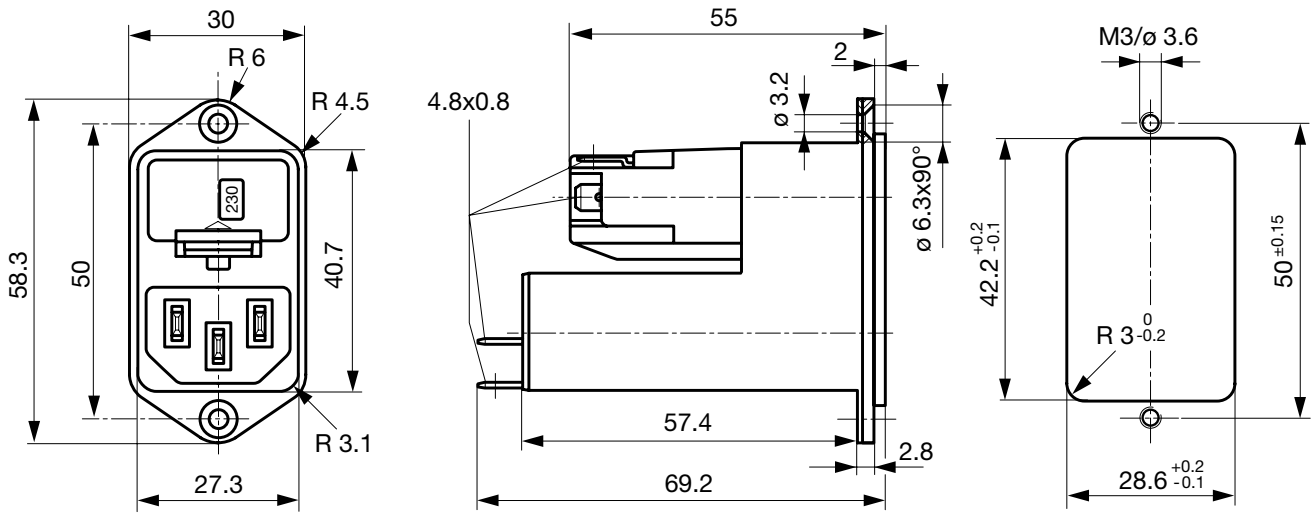

## Technical Data of Filter-Components

| Rated Current [A] | Filter-Type                  | Inductances L [mH] | Capacitance CX [nF] | Capacitance CY [nF] | R [M $\Omega$ ] |
|-------------------|------------------------------|--------------------|---------------------|---------------------|-----------------|
| 1                 | Standard Version             | 2 x 10             | 68                  | 2.2                 | -               |
| 2                 | Standard Version             | 2 x 4              | 68                  | 2.2                 | -               |
| 4                 | Standard Version             | 2 x 1.5            | 68                  | 2.2                 | -               |
| 6                 | Standard Version             | 2 x 0.8            | 68                  | 2.2                 | -               |
| 10                | Standard Version             | 2 x 0.3            | 68                  | 2.2                 | -               |
| 1                 | Medical Version (M5)         | 2 x 10             | 68                  | -                   | 1               |
| 2                 | Medical Version (M5)         | 2 x 4              | 68                  | -                   | 1               |
| 4                 | Medical Version (M5)         | 2 x 1.5            | 68                  | -                   | 1               |
| 6                 | Medical Version (M5)         | 2 x 0.8            | 68                  | -                   | 1               |
| 10                | Medical Version (M5)         | 2 x 0.3            | 68                  | -                   | 1               |
| 10                | Standard and Medical Version | 2 x 0.3            | 68                  | 2.2                 | 1               |

## Diagrams

Standard version with voltage selector

Medical version with voltage selector

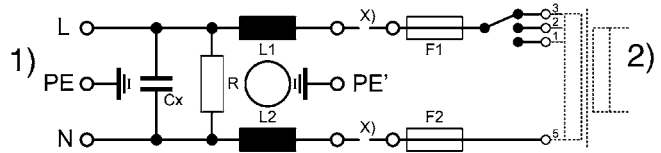
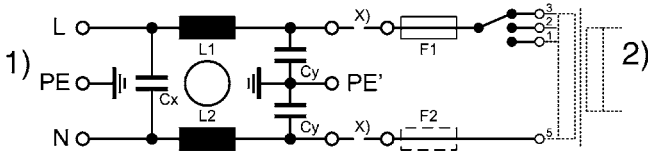

x) external connection to be made by the customer  
 1) Line  
 2) Load

x) external connection to be made by the customer  
 1) Line  
 2) Load

**Derating Curves**

Fuses

5 x 20 mm (1-pole)

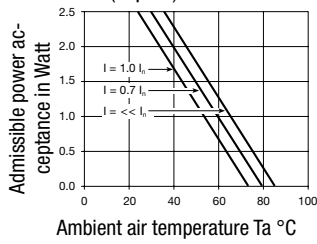

Fuses

5 x 20 mm (2-pole, per pole)

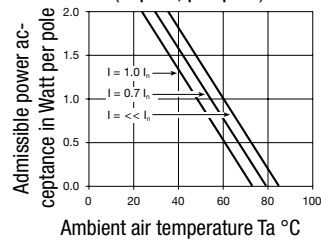

Fuses

6.3 x 32 mm (1-pole)

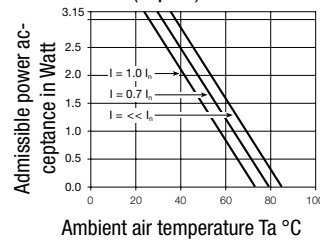

Fuses

6.3 x 32 mm (2-pole, per pole)

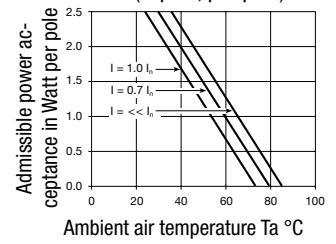

**Attenuation Loss**

--- differential mode    \_\_\_\_ common mode

Standard version

1 A

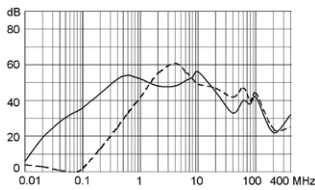

2 A

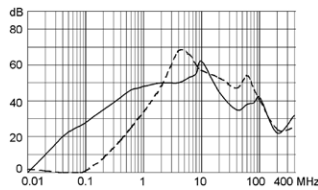

4 A

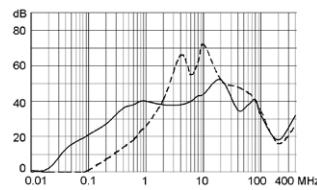

6 A

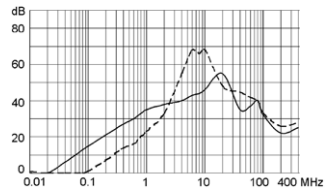

10 A

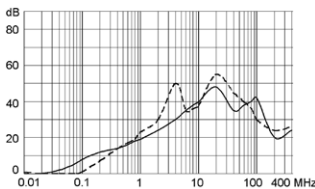

Medical version (M5)

1 A

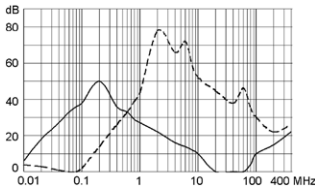

2 A

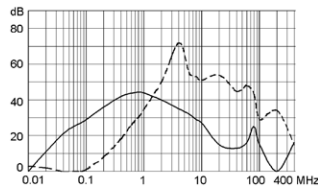

4 A

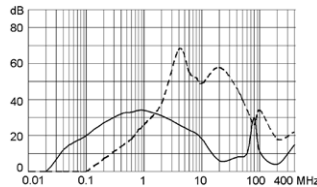

6 A

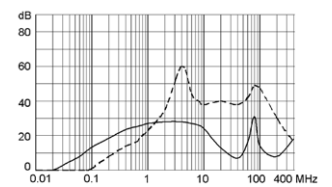

10 A

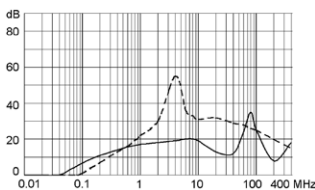

## Variants

Fuse drawer must be ordered separately (see accessories).

| Rated Current [A] | Filter-Type          | Fuseholder | Voltage Selector | Order Number |
|-------------------|----------------------|------------|------------------|--------------|
| 1                 | Standard Version     | 1-pole     | -                | 4303.5011    |
| 2                 | Standard Version     | 1-pole     | -                | 4303.5012    |
| 4                 | Standard Version     | 1-pole     | -                | 4303.5013    |
| 6                 | Standard Version     | 1-pole     | -                | 4303.5014    |
| 10                | Standard Version     | 1-pole     | -                | 4303.5015    |
| 1                 | Standard Version     | 1-pole     | 3 pos.           | 4303.5031    |
| 2                 | Standard Version     | 1-pole     | 3 pos.           | 4303.5032    |
| 4                 | Standard Version     | 1-pole     | 3 pos.           | 4303.5033    |
| 6                 | Standard Version     | 1-pole     | 3 pos.           | 4303.5034    |
| 10                | Standard Version     | 1-pole     | 3 pos.           | 4303.5035    |
| 1                 | Standard Version     | 2-pole     | -                | 4303.5001    |
| 2                 | Standard Version     | 2-pole     | -                | 4303.5002    |
| 4                 | Standard Version     | 2-pole     | -                | 4303.5003    |
| 6                 | Standard Version     | 2-pole     | -                | 4303.5004    |
| 10                | Standard Version     | 2-pole     | -                | 4303.5005    |
| 1                 | Standard Version     | 2-pole     | 3 pos.           | 4303.5021    |
| 2                 | Standard Version     | 2-pole     | 3 pos.           | 4303.5022    |
| 4                 | Standard Version     | 2-pole     | 3 pos.           | 4303.5023    |
| 6                 | Standard Version     | 2-pole     | 3 pos.           | 4303.5024    |
| 10                | Standard Version     | 2-pole     | 3 pos.           | 4303.5025    |
| 1                 | Medical Version (M5) | 2-pole     | 3 pos.           | 4303.5221    |
| 2                 | Medical Version (M5) | 2-pole     | 3 pos.           | 4303.5223    |
| 4                 | Medical Version (M5) | 2-pole     | 3 pos.           | 4303.5225    |
| 6                 | Medical Version (M5) | 2-pole     | 3 pos.           | 4303.5227    |
| 10                | Medical Version (M5) | 2-pole     | 3 pos.           | 4303.5229    |

■ Most Popular.

Availability for all products can be searched real-time: <http://www.schurter.com/en/Stock-Check/Stock-Check-SCHURTER>

**Packaging unit** 10 Pcs

## Required Accessory

### Description



**Fusedrawer 3**  
Fusedrawer for Fuse Links 5x20 mm resp. 6.3x32 mm

Accessories

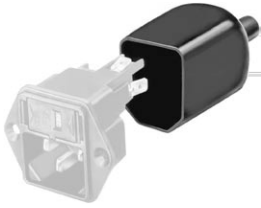

Assorted Covers  
Rear Cover



Cord retaining kits  
Cord retaining strain relief

Mating Outlets/Connectors

Category / Description



Appliance Outlet Overview complete

|   |      |
|---|------|
| IEC Appliance Outlet F, Screw-on Mounting, Front Side, Solder Terminal                            | 4787 |
| IEC Appliance Outlet F, Snap-in Mounting, Front Side, Solder or Quick-connect Terminal            | 4788 |
| IEC Appliance Outlet F or H, Screw-on Mounting, Front Side, Solder, PCB or Quick-connect Terminal | 5091 |

[Appliance Outlet further types to KFC](#)

Connector Overview complete



|  |        |
|--|--------|
| IEC Connector C15A, Rewireable, Straight | 0102   |
| IEC Connector C15A, Rewireable, Straight | 0102-G |
| IEC Connector C15A, Rewireable, Angled   | 0112   |
| IEC Connector C13, Rewireable, Angled    | 4012   |
| IEC Connector C13, Rewireable, Straight  | 4022   |

[Connector further types to KFC](#)